

e-zsert® 



BUYER'S GUIDE 06/2018

e-zsert  [®]





Thin Wall Kits.....	2
Heavy Wall Kits	3
Bulk Thin Wall Inserts Carbon Steel.....	4
Bulk Thin Wall Inserts Stainless Steel	4
Bulk Heavy Wall Inserts Carbon Steel.....	5
Bulk Heavy Wall Inserts Stainless Steel	5
Bulk Extra Heavy Wall Inserts Carbon Steel	6
Technical.....	7

STRONG THREADS IN METAL ... EASY STEPS

E-ZSERTS provide a stronger fastener assembly in soft materials such as aluminum, magnesium and even cast iron. They can be used for repairing stripped threads, and for use in creating stronger threads in original equipment.

E-ZSERT external threads are manufactured with standard size and pitch to permit the use of standard drills and taps. E-ZSERTS can be installed with a screwdriver, bolt/jam nut, or optional power drive tool.

E-ZSERTS are vibration resistant. Immediately upon installation, micro-encapsulated adhesive begins to set, and the newly installed inserts are fastener-ready in 3-5 minutes and will not back out.

The Loctite® adhesive seals against liquids and gases up to 6,000 psi when fully cured after 72 hours.

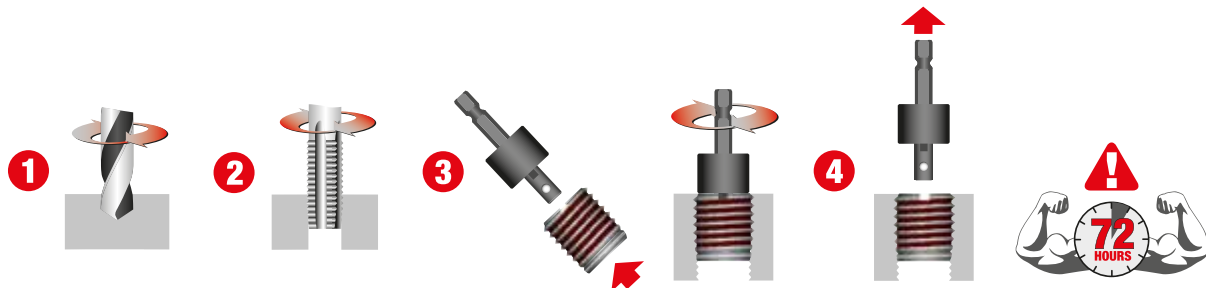

SINGLE SIZE AND RANGE KITS

THIN WALL



GROUP	EZST	EZST
INSERT TYPE	E-ZSERT FOR METAL	E-ZSERT FOR METAL
INSERT MATERIAL	C12L14 CARBON STEEL	303 STAINLESS STEEL
STYLE	THIN WALL	THIN WALL

UNC / UNF SERIES

INCH	TPI	INCH X TPI	INCH	PART #	REF. #	PART #	REF. #	#	DRILL	TAP	PART #
10G	24	5/16 X 18	0.312	3332-10GTWK	EZ-310-3			10	I	5/16-18	3300-2
10G	32	5/16 X 18	0.312	3334-10GTWK	EZ-310-332			10	I	5/16-18	3300-2
1/4	20	3/8 X 16	0.375	3332-1/4TWK	EZ-310-4			10	Q	3/8-16	3300-3
1/4	28	3/8 X 16	0.375	3334-1/4TWK	EZ-310-428			10	Q	3/8-16	3300-3
5/16	18	7/16 X 14	0.437	3332-5/16TWK	EZ-310-5			10	X	7/16-14	3300-4
5/16	24	7/16 X 14	0.437	3334-5/16TWK	EZ-310-524			10	X	7/16-14	3300-4
3/8	16	1/2 X 13	0.500	3332-3/8TWK	EZ-310-6			10	29/64	1/2-13	3300-5
3/8	24	1/2 X 13	0.500	3334-3/8TWK	EZ-310-624			10	29/64	1/2-13	3300-5
7/16	14	9/16 X 12	0.560	3332-7/16TWK	EZ-310-7			10	33/64	9/16-12	3300-6
1/2	13	5/8 X 11	0.620	3332-1/2TWK	EZ-310-8			10	37/64	5/8-11	3300-7

METRIC SERIES

MM	MM	MM X MM	MM	PART #	REF. #	PART #	REF. #	#	DRILL	TAP	PART #
4.00	0.70	8.00 X 1.25	7.5	3320-4.00TWMK	EZ-450-4			10	6.9	M8-1.25	3300-1
5.00	0.80	8.00 X 1.25	7.5	3320-5.00TWMK	EZ-450-5	3320-5.00TWMSSK		10	6.9	M8-1.25	3300-1
6.00	1.00	10.00 X 1.50	10.5	3320-6.00TWMK	EZ-450-6	3320-6.00TWMSSK		10	8.6	M10-1.5	3300-3
8.00	1.25	12.00 X 1.75	12.5	3320-8.00TWMK	EZ-450-8	3320-8.00TWMSSK		10	10.4	M12-1.75	3300-4
10.00	1.50	16.00 X 2.00	17.0	3320-10.00TWMK	EZ-450-10	3320-10.00TWMSSK		10	14.0	M16-2.0	3300-5
12.00	1.75	16.00 X 2.00	17.0	3320-12.00TWMK		3320-12.00TWMSSK		10	14.0	M16-2.0	3300-6
16.00	2.00	24.00 X 3.00	20.0	3320-16.00TWMK				5	21.0	M24-3.0	3300-8

GROUP	EZST
INSERT TYPE	E-ZSERT FOR METAL
INSERT MATERIAL	C12L14 CARBON STEEL
STYLE	THIN WALL

METRIC SERIES – RANGE KIT

MM	MM	MM X MM	MM	PART #	REF. #	#
5.00	0.80	8.00 X 1.25	7.5	3320-WK1		10
6.00	1.00	10.00 X 1.50	10.5			10
8.00	1.25	12.00 X 1.75	12.5			10
10.00	1.50	16.00 X 2.00	17.0			10
12.00	1.75	16.00 X 2.00	17.0			10





GROUP	EZST	EZST
INSERT TYPE	E-ZSERT FOR METAL	E-ZSERT FOR METAL
INSERT MATERIAL	C12L14 CARBON STEEL	303 STAINLESS STEEL
STYLE	HEAVY WALL	HEAVY WALL

UNC / UNF SERIES

INCH	TPI	INCH X TPI	INCH	PART #	REF. #	PART #	REF. #	#	DRILL	TAP	PART #
10G	24	3/8 X 16	0.406	3332-10GHWK	EZ-329-3	3332-10GHWSSK		10	5/16	3/8-16	3300-2
10G	32	3/8 X 16	0.406	3334-10GHWK	EZ-329-332	3334-10GHWSSK		10	5/16	3/8-16	3300-2
1/4	20	7/16 X 14	0.437	3332-1/4HWK	EZ-329-4	3332-1/4HWSSK		10	23/64	7/16-14	3300-3
1/4	28	7/16 X 14	0.437	3334-1/4HWK	EZ-329-428			10	23/64	7/16-14	3300-3
5/16	18	1/2 X 13	0.484	3332-5/16HWK	EZ-329-5	3332-5/16HWSSK		10	27/64	1/2-13	3300-4
5/16	24	1/2 X 13	0.484	3334-5/16HWK	EZ-329-524			10	27/64	1/2-13	3300-4
3/8	16	9/16 X 12	0.515	3332-3/8HWK	EZ-329-6	3332-3/8HWSSK		10	31/64	9/16-12	3300-5
3/8	24	9/16 X 12	0.515	3334-3/8HWK	EZ-329-624			10	31/64	9/16-12	3300-5
7/16	14	5/8 X 11	0.656	3332-7/16HWK	EZ-329-7			10	17/32	5/8-11	3300-6
1/2	13	3/4 X 10	0.656	3332-1/2HWK	EZ-329-8	3332-1/2HWSSK		10	21/32	3/4-10	3300-7
1/2	20	3/4 X 10	0.656	3334-1/2HWK	EZ-329-820			10	21/32	3/4-10	3300-7
5/8	11	7/8 X 9	0.687	3332-5/8HWK	EZ-329-10			5	49/64	7/8-9	3300-9

GROUP	EZST
INSERT TYPE	E-ZSERT FOR METAL
INSERT MATERIAL	C12L14 CARBON STEEL
STYLE	HEAVY WALL

UNC / UNF SERIES – RANGE KIT

INCH	TPI	INCH X TPI	INCH	PART #	REF. #	#
10G	24	3/8 X 16	0.406	3332-WK1	EZ-C108	10
1/4	20	7/16 X 14	0.437			10
5/16	18	1/2 X 13	0.484			10
3/8	16	9/16 X 12	0.515			10
1/2	13	3/4 X 10	0.656			10





GROUP	EZST	EZST
INSERT TYPE	E-ZSERT FOR METAL	E-ZSERT FOR METAL
INSERT MATERIAL	C12L14 CARBON STEEL	303 STAINLESS STEEL
STYLE	THIN WALL	THIN WALL

UNC / UNF SERIES

INCH		INCH X TPI		INCH	PART #	REF. #	PART #	REF. #	DRILL INCH	TAP SIZE	MIN. FULL THREAD DEPTH	PART #
10G	24	5/16 X 18	0.312	3332-10GTW	319-3				I	5/16-18	0.375	3300-2
10G	32	5/16 X 18	0.312	3334-10GTW	319-332				I	5/16-18	0.375	3300-2
1/4	20	3/8 X 16	0.375	3332-1/4TW	319-4				Q	3/8-16	0.437	3300-3
1/4	28	3/8 X 16	0.375	3334-1/4TW	319-428				Q	3/8-16	0.437	3300-3
5/16	18	7/16 X 14	0.437	3332-5/16TW	319-5				X	7/16-14	0.500	3300-4
5/16	24	7/16 X 14	0.437	3334-5/16TW	319-524				X	7/16-14	0.500	3300-4
3/8	16	1/2 X 13	0.500	3332-3/8TW	319-6				29/64	1/2-13	0.560	3300-5
3/8	24	1/2 X 13	0.500	3334-3/8TW	319-624				29/64	1/2-13	0.560	3300-5
7/16	14	9/16 X 12	0.560	3332-7/16TW	319-7				33/64	9/16-12	0.620	3300-6
7/16	20	9/16 X 12	0.560	3334-7/16TW	319-720				33/64	9/16-12	0.620	3300-6
1/2	13	5/8 X 11	0.620	3332-1/2TW	319-8				37/64	5/8-11	0.680	3300-7
1/2	20	5/8 X 11	0.620	3334-1/2TW	319-820				37/64	5/8-11	0.680	3300-7

METRIC INTERNAL UNC EXTERNAL SERIES

MM	MM	INCH X TPI	INCH	PART #	REF. #	PART #	REF. #	DRILL INCH	TAP SIZE	MIN. FULL THREAD DEPTH	PART #	
4.00	0.70	5/16 X 18	0.312	3320-4.00TWF	319-M4				I	5/16-18	0.375	3300-1
5.00	0.80	5/16 X 18	0.312	3320-5.00TWF	319-M5				I	5/16-18	0.375	3300-2
6.00	1.00	3/8 X 16	0.375	3320-6.00TWF	319-M6				Q	3/8-16	0.437	3300-3
8.00	1.25	7/16 X 14	0.437	3320-8.00TWF	319-M6				X	7/16-14	0.500	3300-4
10.00	1.50	1/2 X 13	0.500	3320-10.00TWF	319-M10				29/64	1/2-13	0.560	3300-5
12.00	1.75	5/8 X 11	0.620	3320-12.00TWF	319-M12				37/64	5/8-11	0.680	3300-6

METRIC SERIES

MM	MM	MM X MM	MM	PART #	REF. #	PART #	REF. #	DRILL MM	TAP SIZE	MIN. FULL THREAD DEPTH	PART #
3.00	0.50	6.00 X 1.0	6.5	3320-3.00TWM	450-3	3320-3.00TWMSS	453-3	5.1	M6-1.0	7.8	
4.00	0.70	8.00 X 1.25	7.5	3320-4.00TWM	450-4	3320-4.00TWMSS	453-4	6.9	M8-1.25	9.0	3300-1
5.00	0.80	8.00 X 1.25	7.5	3320-5.00TWM	450-5	3320-5.00TWMSS	453-5	6.9	M8-1.25	9.0	3300-2
6.00	1.00	10.00 X 1.50	10.5	3320-6.00TWM	450-6	3320-6.00TWMSS	453-6	8.6	M10-1.5	12.0	3300-3
8.00	1.25	12.00 X 1.75	12.5	3320-8.00TWM	450-8	3320-8.00TWMSS	453-8	10.4	M12-1.75	14.5	3300-4
10.00	1.50	16.00 X 2.00	17.0	3320-10.00TWM	450-10	3320-10.00TWMSS	453-10	14.0	M16-2.0	19.0	3300-5
12.00	1.75	16.00 X 2.00	17.0	3320-12.00TWM	450-12	3320-12.00TWMSS	453-12	14.0	M16-2.0	19.0	3300-6
16.00	2.00	24.00 X 3.00	20.0	3320-16.00TWM	450-16	3320-16.00TWMSS	453-16	21.0	M24-3.0	24.0	3300-8
20.00	2.50	36.00 X 4.00	30.0	3320-20.00TWM	450-20			33.0	M36-4.0	35.0	



GROUP	EZST	EZST
INSERT TYPE	E-ZSERT FOR METAL	E-ZSERT FOR METAL
INSERT MATERIAL	C12L14 CARBON STEEL	303 STAINLESS STEEL
STYLE	HEAVY WALL	HEAVY WALL

UNC / UNF SERIES

INCH	TPI	INCH X TPI	INCH	PART #	REF. #	PART #	REF. #	DRILL INCH	TAP SIZE	MIN. FULL THREAD DEPTH	PART #		
4G	40	10 X 32	0.250	3332-4GHW	329-004	3332-4GHWSS	303-004	5/32	10-32	0.281			
6G	32	1/4 X 20	0.280	3332-6GHW	329-006	3332-6GHWSS	303-006	#7	1/4-20	0.344	3300-006		
8G	32	5/16 X 18	0.290	3332-8GHW	329-008	3332-8GHWSS	303-008	F	5/16-18	0.438	3300-1		
10G	24	3/8 X 16	0.406	3332-10GHW	329-3	3332-10GHWSS	303-3	5/16	3/8-16	0.469	3300-2		
10G	32	3/8 X 16	0.406	3334-10GHW	329-332	3334-10GHWSS	303-332	5/16	3/8-16	0.469	3300-2		
1/4	20	7/16 X 14	0.437	3332-1/4HW	329-4	3332-1/4HWSS	303-4	23/64	7/16-14	0.500	3300-3		
1/4	28	7/16 X 14	0.437	3334-1/4HW	329-428	3334-1/4HWSS	303-428	23/64	7/16-14	0.500	3300-3		
5/16	18	1/2 X 13	0.484	3332-5/16HW	329-5	3332-5/16HWSS	303-5	27/64	1/2-13	0.563	3300-4		
5/16	24	1/2 X 13	0.484	3334-5/16HW	329-524	3334-5/16HWSS	303-524	27/64	1/2-13	0.563	3300-4		
3/8	16	9/16 X 12	0.515	3332-3/8HW	329-6	3332-3/8HWSS	303-6	31/64	9/16-12	0.594	3300-5		
3/8	24	9/16 X 12	0.515	3334-3/8HW	329-624	3334-3/8HWSS	303-624	31/64	9/16-12	0.594	3300-5		
7/16	14	5/8 X 11	0.656	3332-7/16HW	329-7	3332-7/16HWSS	303-7	17/32	5/8-11	0.719	3300-6		
7/16	24	5/8 X 11	0.656	3334-7/16HW	329-720	3334-7/16HWSS	303-720	17/32	5/8-11	0.719	3300-6		
1/2	13	3/4 X 10	0.656	3332-1/2HW	329-8	3332-1/2HWSS	303-8	21/32	3/4-10	0.750	3300-7		
1/2	13	3/4 X 10	1.000	3332-1/2X1HW	329-801			21/32	3/4-10	1.125	3300-7		
1/2	20	3/4 X 10	0.656	3334-1/2HW	329-820	3334-1/2HWSS	303-820	21/32	3/4-10	0.750	3300-7		
9/16	12	3/4 X 10	0.656	3332-9/16HW	329-9			21/32	3/4-10	0.750	3300-7		
9/16	18	3/4 X 10	0.656	3334-9/16HW	329-918			21/32	3/4-10	0.750	3300-7		
5/8	11	7/8 X 9	0.687	3332-5/8HW	329-10	3332-5/8HWSS	303-10	49/64	7/8-9	0.813	3300-8		
5/8	11	7/8 X 9	1.125	3332-5/8X1.125HW	329-1018			49/64	7/8-9	1.250	3300-8		
5/8	18	7/8 X 9	0.687	3334-5/8HW	329-10F			49/64	7/8-9	0.813	3300-8		
3/4	10	1 X 8	0.781	3332-3/4HW	329-12	3332-3/4HWSS	303-12	7/8	1-8	0.875	3300-9		
3/4	16	1 X 8	0.781	3334-3/4HW	329-1216			7/8	1-8	0.875	3300-9		
7/8	9	1.1/4 X 7	1.125	3332-7/8HW	329-14			1-7/64	1.1/4-7	1.250			
7/8	14	1.1/4 X 7	1.125	3334-7/8HW	329-1414			1-7/64	1.1/4-7	1.250			
1	8	1.3/8 X 12	1.250	3332-1HW	329-16			1-9/32	1.3/8-12	1.375			
1	14	1.3/8 X 12	1.250	3334-1HW	329-1614			1-9/32	1.3/8-12	1.375			

UNC INTERNAL METRIC EXTERNAL SERIES

INCH	TPI	MM X MM	INCH	PART #	REF. #	PART #	REF. #	DRILL INCH	TAP SIZE	MIN. FULL THREAD DEPTH	PART #		
6G	32	6.00 X 1.0	0.256	3332-6GHWM	550-006			5.1	M6-1.0	7.8			
8G	32	8.00 X 1.25	0.295	3332-8GHWM	550-008			6.9	M8-1.25	9.0	3300-1		
10G	24	8.00 X 1.25	0.295	3332-10GHWM	550-1024			6.9	M8-1.25	12.0	3300-2		
10G	32	8.00 X 1.25	0.295	3334-10GHWM	550-1032			6.9	M8-1.25	12.0	3300-2		
1/4	20	10.00 X 1.50	0.413	3332-1/4HWM	550-1420			8.6	M10-1.5	14.5	3300-3		
5/16	18	12.00 X 1.75	0.492	3332-5/16HWM	550-5			10.4	M12-1.75	14.5	3300-4		
3/8	16	16.00 X 2.00	0.669	3332-3/8HWM	550-6			14.0	M16-2.0	19.0	3300-5		
1/2	13	16.00 X 2.00	0.669	3332-1/2HWM	550-8			14.0	M16-2.0	19.0	3300-7		



GROUP	EZST	EZST
INSERT TYPE	E-ZSERT FOR METAL	E-ZSERT FOR METAL
INSERT MATERIAL	C12L14 CARBON STEEL	303 STAINLESS STEEL
STYLE	HEAVY WALL	HEAVY WALL

METRIC INTERNAL UNC EXTERNAL SERIES

MM	MM	INCH X TPI	INCH	PART #	REF. #	PART #	REF. #	DRILL INCH	TAP SIZE	MIN. FULL THREAD DEPTH	PART #
6.00	1.00	3/8 X 16	0.406	3320-6.00HWF	650-6	3320-6.00HWSSF	653-6	5/16	3/8-16	0.469	3300-3
8.00	1.25	1/2 X 13	0.484	3320-8.00HWF	650-8	3320-8.00HWSSF	653-8	27/64	1/2-13	0.563	3300-4
10.00	1.50	9/16 X 12	0.515	3320-10.00HWF	650-10	3320-10.00HWSSF	653-10	31/64	9/16-12	0.594	3300-5
10.00	1.25	9/16 X 12	0.515	3321-10.00HWF	650-10F	3320-10.00HWSSF	653-10F	31/64	9/16-12	0.594	3300-5
12.00	1.75	3/4 X 10	0.656	3320-12.00HWF	650-12	3320-12.00HWSSF	653-12	21/32	3/4-10	0.750	3300-6
14.00	2.00	7/8 X 9	0.687	3320-14.00HWF	650-14	3320-14.00HWSSF	653-14	49/64	7/8-9	0.813	3300-7
16.00	2.00	1 X 8	0.781	3320-16.00HWF	650-16	3320-16.00HDSSF	653-16	7/8	1-8	0.875	3300-8



GROUP	EZST	EZST
INSERT TYPE	E-ZSERT FOR METAL	E-ZSERT FOR METAL
INSERT MATERIAL	C12L14 CARBON STEEL	303 STAINLESS STEEL
STYLE	EXTRA HEAVY WALL	EXTRA HEAVY WALL

UNC SERIES

INCH	TPI	INCH X TPI	INCH	PART #	REF. #	PART #	REF. #	DRILL INCH	TAP SIZE	MIN. FULL THREAD DEPTH	PART #
1/4	20	1/2 X 13	0.484	3332-1/4XHW	335-4			27/64	1/2-13	0.563	3300-3
5/16	18	9/16 X 12	0.515	3332-5/16XHW	335-5			31/64	9/16-12	0.594	3300-4
3/8	16	5/8 X 11	0.656	3332-3/8XHW	335-6			17/32	5/8-11	0.719	3300-5
1/2	13	7/8 X 9	0.687	3332-1/2XHW	335-8			49/64	7/8-9	0.813	
5/8	11	1 X 8	0.781	3332-5/8XHW	335-10			7/8	1-8	0.875	

INSERT STYLE
THIN WALL

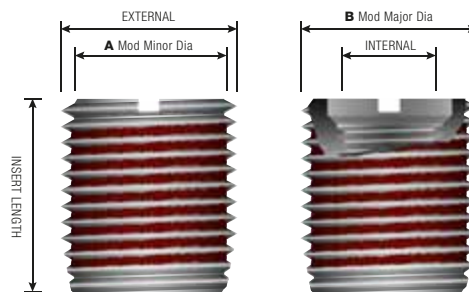

UNC / UNF SERIES

PART #	INTERNAL THREAD INCH 2B	EXTERNAL THREAD INCH 2B	MATERIAL	L INCH	A MOD MINOR DIA. INCH	B MAJOR DIA. INCH
3332-10GTW	10-24	5/16-18	C12L14 Carbon Steel	0.312	.251 - .254	.307 - .311
3334-10GTW	10-32	5/16-18	C12L14 Carbon Steel	0.312	.251 - .254	.307 - .311
3332-1/4TW	1/4-20	3/8-16	C12L14 Carbon Steel	0.375	.314 - .318	.369 - .373
3334-1/4TW	1/4-28	3/8-16	C12L14 Carbon Steel	0.375	.314 - .318	.369 - .373
3332-5/16TW	5/16-18	7/16-14	C12L14 Carbon Steel	0.437	.377 - .381	.432 - .436
3334-5/16TW	5/16-24	7/16-14	C12L14 Carbon Steel	0.437	.377 - .381	.432 - .436
3332-3/8TW	3/8-16	1/2-13	C12L14 Carbon Steel	0.500	.434 - .438	.494 - .498
3334-3/8TW	3/8-24	1/2-13	C12L14 Carbon Steel	0.500	.434 - .438	.494 - .498
3332-7/16TW	7/16-14	9/16-12	C12L14 Carbon Steel	0.560	.497 - .501	.556 - .560
3334-7/16TW	7/16-20	9/16-12	C12L14 Carbon Steel	0.560	.497 - .501	.556 - .560
3332-1/2TW	1/2-13	5/8-11	C12L14 Carbon Steel	0.620	.553 - .557	.619 - .623
3334-1/2TW	1/2-20	5/8-11	C12L14 Carbon Steel	0.620	.553 - .557	.619 - .623

METRIC INTERNAL UNC EXTERNAL SERIES

PART #	INTERNAL THREAD MM 6H	EXTERNAL THREAD INCH 2B	MATERIAL	L INCH	A MOD MINOR DIA. INCH	B MAJOR DIA. INCH
3320-4.00TWF	M4-0.7	5/16-18	C12L14 Carbon Steel	0.312	.251 - .254	.307 - .311
3320-5.00TWF	M5-0.8	5/16-18	C12L14 Carbon Steel	0.312	.251 - .254	.307 - .311
3320-6.00TWF	M6-1.0	3/8-16	C12L14 Carbon Steel	0.375	.314 - .318	.369 - .373
3320-8.00TWF	M8-1.25	7/16-14	C12L14 Carbon Steel	0.437	.377 - .381	.432 - .436
3320-10.00TWF	M10-1.5	1/2-13	C12L14 Carbon Steel	0.500	.434 - .438	.494 - .498
3320-12.00TWF	M12-1.75	5/8-11	C12L14 Carbon Steel	0.625	.553 - .557	.619 - .623

INSERT STYLE
THIN WALL

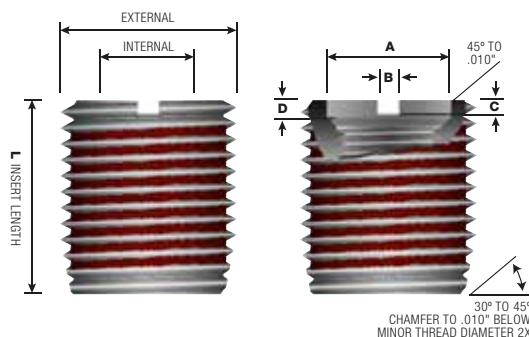

METRIC SERIES

PART #	INTERNAL THREAD MM 6H	EXTERNAL THREAD MM 6G	MATERIAL	L MM	A MM	B MM	C MM	D MM
3320-3.00TWM	M3-0.5	M6-1.0	C12L14 Carbon Steel	6.5	3.25	1.14	1.57	1.91
3320-4.00TWM	M4-0.7	M8-1.25	C12L14 Carbon Steel	7.5	4.32	1.65	1.65	1.91
3320-5.00TWM	M5-0.8	M8-1.25	C12L14 Carbon Steel	7.5	5.33	1.65	1.65	1.91
3320-6.00TWM	M6-1.0	M10-1.5	C12L14 Carbon Steel	10.5	6.35	1.83	1.83	2.03
3320-8.00TWM	M8-1.25	M12-1.75	C12L14 Carbon Steel	12.5	8.33	1.83	1.83	2.03
3320-10.00TWM	M10-1.5	M16-2.0	C12L14 Carbon Steel	17.0	10.31	2.62	2.16	2.41
3320-12.00TWM	M12-1.75	M16-2.0	C12L14 Carbon Steel	17.0	12.32	3.35	2.79	2.92
3320-16.00TWM	M16-2.0	M24-3.0	C12L14 Carbon Steel	20.0	16.66	3.35	3.18	3.30
3320-20.00TWM	M20-2.5	M36-4.0	C12L14 Carbon Steel	30.0	20.50	3.35	3.35	3.56

INSERT STYLE

THIN WALL

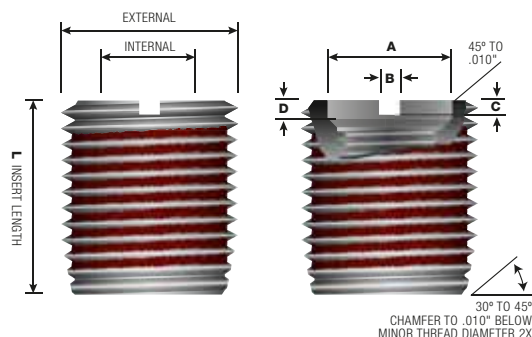

METRIC SERIES

PART #	INTERNAL THREAD MM 6H	EXTERNAL THREAD MM 6G	MATERIAL	L MM	A MM	B MM	C MM	D MM
3320-3.00HWMSS	M3-0.5	M6-1.0	303 Stainless Steel	6.5	3.25	1.14	1.57	1.91
3320-4.00HWMSS	M4-0.7	M8-1.25	303 Stainless Steel	7.5	4.32	1.65	1.65	1.91
3320-5.00HWMSS	M5-0.8	M8-1.25	303 Stainless Steel	7.5	5.33	1.65	1.65	1.91
3320-6.00HWMSS	M6-1.0	M10-1.5	303 Stainless Steel	10.5	6.35	1.83	1.83	2.03
3320-8.00HWMSS	M8-1.25	M12-1.75	303 Stainless Steel	12.5	8.33	1.83	1.83	2.03
3320-10.00HWMSS	M10-1.5	M16-2.0	303 Stainless Steel	17.0	10.31	2.62	2.16	2.41
3320-12.00HWMSS	M12-1.75	M16-2.0	303 Stainless Steel	17.0	12.32	3.35	2.79	2.92
3320-16.00HWMSS	M16-2.0	M24-3.0	303 Stainless Steel	20.0	16.66	3.35	3.18	3.30

INSERT STYLE

HEAVY WALL



UNC / UNF SERIES

PART #	INTERNAL THREAD INCH 2B	EXTERNAL THREAD INCH 2B	MATERIAL	L INCH	A INCH	B INCH	C INCH	D INCH
3332-4GHW	4-40	10-32	C12L14 Carbon Steel	0.250	0.122	0.064	0.062	0.065
3332-6GHW	6-32	1/4-20	C12L14 Carbon Steel	0.280	0.148	0.064	0.062	0.070
3332-8GHW	8-32	5/16-18	C12L14 Carbon Steel	0.290	0.177	0.064	0.062	0.075
3332-10GHW	10-24	3/8-16	C12L14 Carbon Steel	0.406	0.201	0.064	0.070	0.080
3334-10GHW	10-32	3/8-16	C12L14 Carbon Steel	0.406	0.201	0.064	0.070	0.080
3332-1/4HW	1/4-20	7/16-14	C12L14 Carbon Steel	0.437	0.261	0.072	0.075	0.085
3334-1/4HW	1/4-28	7/16-14	C12L14 Carbon Steel	0.437	0.261	0.072	0.075	0.085
3332-5/16HW	5/16-18	1/2-13	C12L14 Carbon Steel	0.484	0.323	0.081	0.080	0.090
3334-5/16HW	5/16-24	1/2-13	C12L14 Carbon Steel	0.484	0.323	0.081	0.080	0.090
3332-3/8HW	3/8-16	9/16-12	C12L14 Carbon Steel	0.515	0.386	0.091	0.085	0.095
3334-3/8HW	3/8-24	9/16-12	C12L14 Carbon Steel	0.515	0.386	0.091	0.085	0.095
3332-7/16HW	7/16-14	5/8-11	C12L14 Carbon Steel	0.656	0.447	0.130	0.110	0.115
3334-7/16HW	7/16-24	5/8-11	C12L14 Carbon Steel	0.656	0.447	0.130	0.110	0.115
3332-1/2HW	1/2-13	3/4-10	C12L14 Carbon Steel	0.656	0.510	0.130	0.110	0.115
3332-1/2X1HW	1/2-13	3/4-10	C12L14 Carbon Steel	1.000	0.510	0.130	0.110	0.115
3334-1/2HW	1/2-20	3/4-10	C12L14 Carbon Steel	0.656	0.510	0.130	0.110	0.115
3332-9/16HW	9/16-12	3/4-10	C12L14 Carbon Steel	0.656	0.578	0.130	0.110	0.115
3334-9/16HW	9/16-18	3/4-10	C12L14 Carbon Steel	0.656	0.578	0.130	0.110	0.115
3332-5/8HW	5/8-11	7/8-9	C12L14 Carbon Steel	0.687	0.640	0.130	0.125	0.130
3332-5/8X1.125HW	5/8-11	7/8-9	C12L14 Carbon Steel	1.125	0.640	0.130	0.125	0.130
3334-5/8HW	5/8-18	7/8-9	C12L14 Carbon Steel	0.687	0.640	0.130	0.125	0.130
3332-3/4HW	3/4-10	1-8	C12L14 Carbon Steel	0.781	0.765	0.130	0.125	0.130
3334-3/4HW	3/4-16	1-8	C12L14 Carbon Steel	0.781	0.765	0.130	0.125	0.130
3332-7/8HW	7/8-9	1.1/4-7	C12L14 Carbon Steel	1.125	0.890	0.130	0.135	0.130
3334-7/8HW	7/8-14	1.1/4-7	C12L14 Carbon Steel	1.125	0.890	0.130	0.135	0.130
3332-1HW	1-8	1.3/8-12	C12L14 Carbon Steel	1.250	1.020	0.130	0.135	0.140
3334-1HW	1-14	1.3/8-12	C12L14 Carbon Steel	1.250	1.020	0.130	0.135	0.140

INSERT STYLE
HEAVY WALL

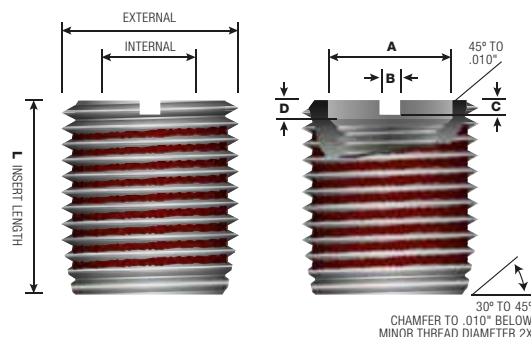

UNC / UNF SERIES

PART #	INTERNAL THREAD INCH 2B	EXTERNAL THREAD INCH 2B	MATERIAL	L INCH	A INCH	B INCH	C INCH	D INCH
3332-4GHWSS	4-40	10-32	303 Stainless Steel	0.250	0.122	0.064	0.602	0.065
3332-6GHWSS	6-32	1/4-20	303 Stainless Steel	0.280	0.148	0.064	0.062	0.070
3332-8GHWSS	8-32	5/16-18	303 Stainless Steel	0.290	0.177	0.064	0.062	0.075
3332-10GHWSS	10-24	3/8-16	303 Stainless Steel	0.406	0.201	0.064	0.070	0.080
3334-10GHWSS	10-32	3/8-16	303 Stainless Steel	0.406	0.201	0.064	0.070	0.080
3332-1/4HWSS	1/4-20	7/16-14	303 Stainless Steel	0.437	0.261	0.072	0.075	0.085
3334-1/4HWSS	1/4-28	7/16-14	303 Stainless Steel	0.437	0.261	0.072	0.075	0.085
3332-5/16HWSS	5/16-18	1/2-13	303 Stainless Steel	0.484	0.323	0.081	0.080	0.090
3334-5/16HWSS	5/16-24	1/2-13	303 Stainless Steel	0.484	0.323	0.081	0.080	0.090
3332-3/8HWSS	3/8-16	9/16-12	303 Stainless Steel	0.515	0.386	0.091	0.085	0.095
3334-3/8HWSS	3/8-24	9/16-12	303 Stainless Steel	0.515	0.386	0.091	0.085	0.095
3332-7/16HWSS	7/16-14	5/8-11	303 Stainless Steel	0.656	0.447	0.130	0.110	0.115
3334-7/16HWSS	7/16-20	5/8-11	303 Stainless Steel	0.656	0.447	0.130	0.110	0.115
3332-1/2HWSS	1/2-13	3/4-10	303 Stainless Steel	0.656	0.510	0.130	0.110	0.115
3334-1/2HWSS	1/2-20	3/4-10	303 Stainless Steel	0.656	0.510	0.130	0.110	0.115
3332-5/8HWSS	5/8-11	7/8-9	303 Stainless Steel	0.687	0.640	0.130	0.125	0.130
3332-3/4HWSS	3/4-10	1-8	303 Stainless Steel	0.781	0.765	0.130	0.125	0.130



UNC INTERNAL METRIC EXTERNAL SERIES

PART #	INTERNAL THREAD INCH 2B	EXTERNAL THREAD MM 6G	MATERIAL	L INCH	A INCH	B INCH	C INCH	D INCH
3332-6GHWM	6-32	M6-1.0	C12L14 Carbon Steel	0.256	0.148	0.064	0.062	0.070
3332-8GHWM	8-32	M8-1.25	C12L14 Carbon Steel	0.295	0.177	0.064	0.062	0.075
3332-10GHWM	10-24	M8-1.25	C12L14 Carbon Steel	0.295	0.201	0.064	0.070	0.080
3334-10GHWM	10-32	M8-1.25	C12L14 Carbon Steel	0.295	0.201	0.064	0.070	0.080
3332-1/4HWM	1/4-20	M10-1.5	C12L14 Carbon Steel	0.413	0.261	0.072	0.075	0.085
3332-5/16HWM	5/16-18	M12-1.75	C12L14 Carbon Steel	0.492	0.323	0.081	0.080	0.090
3332-3/8HWM	3/8-16	M16-2.0	C12L14 Carbon Steel	0.669	0.386	0.091	0.085	0.095
3332-1/2HWM	1/2-13	M16-2.0	C12L14 Carbon Steel	0.669	0.510	0.130	0.110	0.115

METRIC INTERNAL UNC EXTERNAL SERIES

PART #	INTERNAL THREAD MM 6H	EXTERNAL THREAD INCH 2B	MATERIAL	L INCH	A INCH	B INCH	C INCH	D INCH
3320-6.00HWF	M6-1.0	3/8-16	C12L14 Carbon Steel	0.406	0.246	0.064	0.070	0.085
3320-8.00HWF	M8-1.25	1/2-13	C12L14 Carbon Steel	0.484	0.323	0.081	0.080	0.090
3320-10.00HWF	M10-1.5	9/16-12	C12L14 Carbon Steel	0.515	0.403	0.091	0.085	0.095
3321-10.00HWF	M10-1.25	9/16-12	C12L14 Carbon Steel	0.515	0.403	0.091	0.085	0.095
3320-12.00HWF	M12-1.75	3/4-10	C12L14 Carbon Steel	0.656	0.482	0.130	0.110	0.115
3320-14.00HWF	M14-2.0	7/8-9	C12L14 Carbon Steel	0.687	0.640	0.130	0.125	0.130
3320-16.00HWF	M16-2.0	1-8	C12L14 Carbon Steel	0.781	0.640	0.130	0.125	0.130

INSERT STYLE
HEAVY WALL

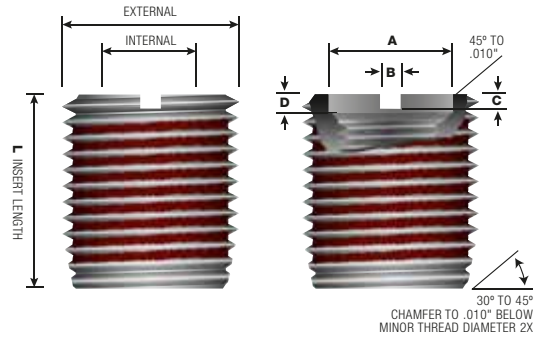

METRIC INTERNAL UNC EXTERNAL SERIES

PART #	INTERNAL THREAD MM 6H	EXTERNAL THREAD INCH 2B	MATERIAL	L MM	A MM	B MM	C MM	D MM
3320-6.00HWSSF	M6-1.0	3/8-16	303 Stainless Steel	0.406	0.246	0.064	0.070	0.085
3320-8.00HWSSF	M8-1.25	1/2-13	303 Stainless Steel	0.484	0.323	0.081	0.080	0.090
3320-10.00HWSSF	M10-1.5	9/16-12	303 Stainless Steel	0.515	0.403	0.091	0.085	0.095
3321-10.00HWSSF	M10-1.25	9/16-12	303 Stainless Steel	0.515	0.403	0.091	0.085	0.095
3320-12.00HWSSF	M12-1.75	3/4-10	303 Stainless Steel	0.656	0.482	0.130	0.110	0.115
3320-14.00HWSSF	M14-2.0	7/8-9	303 Stainless Steel	0.687	0.640	0.130	0.125	0.130
3320-16.00HWSSF	M16-2.0	1-8	303 Stainless Steel	0.781	0.640	0.130	0.125	0.130

INSERT STYLE
EXTRA HEAVY WALL

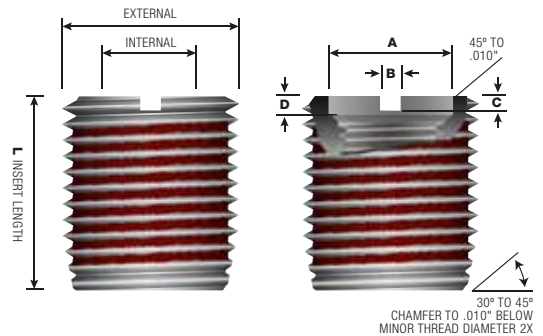

UNC SERIES

PART #	INTERNAL THREAD INCH 2B	EXTERNAL THREAD INCH 2B	MATERIAL	L INCH	A INCH	B INCH	C INCH	D INCH
3332-1/4XHW	1/4-20	1/2-13	C12L14 Carbon Steel	0.484	0.261	0.072	0.075	0.085
3332-5/16XHW	5/16-18	9/16-12	C12L14 Carbon Steel	0.515	0.323	0.081	0.080	0.090
3332-3/8XHW	3/8-16	5/8-11	C12L14 Carbon Steel	0.656	0.385	0.130	0.110	0.115
3332-1/2XHW	1/2-13	7/8-9	C12L14 Carbon Steel	0.687	0.640	0.130	0.125	0.130
3332-5/8XHW	5/8-11	1-8	C12L14 Carbon Steel	0.781	0.760	0.130	0.125	0.130



[The main body of the page is blank white space.]

e-zsert[®]



CROSSROAD DISTRIBUTOR SOURCE

15340 Herriman Blvd,
Noblesville, IN 46060
Sales@Crossroad.bz

CrossroadDistributorSource.com

TEL: 317.723.5050 FAX: 317.723.5052