

**bondsert** 



**BUYER'S GUIDE 07/2021**

**bondsert** 





|  |   |
|--|---|
| Thin Wall Kits.....                              | 2 |
| Heavy Wall Kits .....                            | 3 |
| Bulk Thin Wall Inserts Carbon Steel.....         | 4 |
| Bulk Thin Wall Inserts Stainless Steel .....     | 4 |
| Bulk Heavy Wall Inserts Carbon Steel.....        | 5 |
| Bulk Heavy Wall Inserts Stainless Steel .....    | 5 |
| Bulk Extra Heavy Wall Inserts Carbon Steel ..... | 6 |
| Technical.....                                   | 7 |

## STRONG THREADS IN METAL ... EASY STEPS

BONDSERT provide a stronger fastener assembly in soft materials such as aluminum, magnesium and even cast iron. They can be used for repairing stripped threads, and for use in creating stronger threads in original equipment.

BONDSERT external threads are manufactured with standard size and pitch to permit the use of standard drills and taps. BONDSERTS can be installed with a screwdriver, bolt/jam nut, or optional power drive tool.

BONDSERTS are vibration resistant. Immediately upon installation, micro-encapsulated adhesive begins to set, and the newly installed inserts are fastener-ready in 3-5 minutes and will not back out.

The Loctite® adhesive seals against liquids and gases up to 6,000 psi when fully cured after 72 hours.

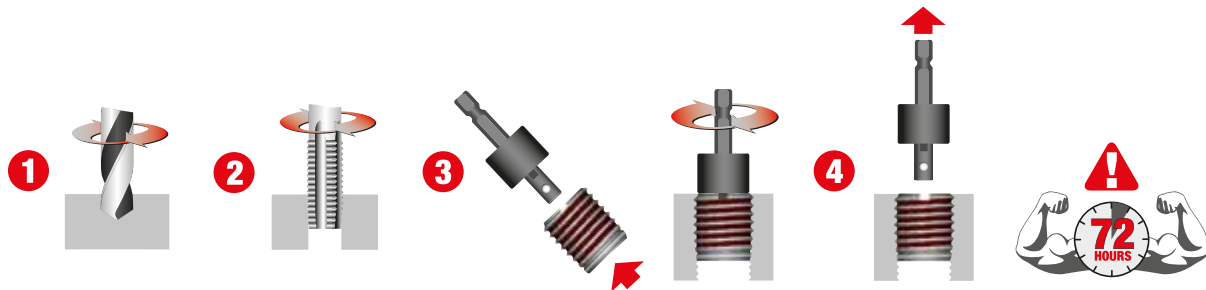



**SINGLE SIZE AND RANGE KITS**

THIN WALL



| GROUP           | EZST                | EZST                |
|-----------------|---------------------|---------------------|
| INSERT TYPE     | BONDSERT FOR METAL  | BONDSERT FOR METAL  |
| INSERT MATERIAL | C12L14 CARBON STEEL | 303 STAINLESS STEEL |
| STYLE           | THIN WALL           | THIN WALL           |

**UNC / UNF SERIES**

| INCH | TPI | INCH X TPI | INCH  | PART #       | REF. #     | PART # | REF. # | #  | DRILL | TAP     | PART # |
|------|-----|------------|-------|--------------|------------|--------|--------|----|-------|---------|--------|
| 10G  | 24  | 5/16 X 18  | 0.312 | 3332-10GTWK  | EZ-310-3   |        |        | 10 | I     | 5/16-18 | 3300-2 |
| 10G  | 32  | 5/16 X 18  | 0.312 | 3334-10GTWK  | EZ-310-332 |        |        | 10 | I     | 5/16-18 | 3300-2 |
| 1/4  | 20  | 3/8 X 16   | 0.375 | 3332-1/4TWK  | EZ-310-4   |        |        | 10 | Q     | 3/8-16  | 3300-3 |
| 1/4  | 28  | 3/8 X 16   | 0.375 | 3334-1/4TWK  | EZ-310-428 |        |        | 10 | Q     | 3/8-16  | 3300-3 |
| 5/16 | 18  | 7/16 X 14  | 0.437 | 3332-5/16TWK | EZ-310-5   |        |        | 10 | X     | 7/16-14 | 3300-4 |
| 5/16 | 24  | 7/16 X 14  | 0.437 | 3334-5/16TWK | EZ-310-524 |        |        | 10 | X     | 7/16-14 | 3300-4 |
| 3/8  | 16  | 1/2 X 13   | 0.500 | 3332-3/8TWK  | EZ-310-6   |        |        | 10 | 29/64 | 1/2-13  | 3300-5 |
| 3/8  | 24  | 1/2 X 13   | 0.500 | 3334-3/8TWK  | EZ-310-624 |        |        | 10 | 29/64 | 1/2-13  | 3300-5 |
| 7/16 | 14  | 9/16 X 12  | 0.560 | 3332-7/16TWK | EZ-310-7   |        |        | 10 | 33/64 | 9/16-12 | 3300-6 |
| 1/2  | 13  | 5/8 X 11   | 0.620 | 3332-1/2TWK  | EZ-310-8   |        |        | 10 | 37/64 | 5/8-11  | 3300-7 |

**METRIC SERIES**

| MM    | MM   | MM X MM      | MM   | PART #         | REF. #    | PART #           | REF. # | #  | DRILL | TAP      | PART # |
|-------|------|--------------|------|----------------|-----------|------------------|--------|----|-------|----------|--------|
| 4.00  | 0.70 | 8.00 X 1.25  | 7.5  | 3320-4.00TWMK  | EZ-450-4  |                  |        | 10 | 6.9   | M8-1.25  | 3300-1 |
| 5.00  | 0.80 | 8.00 X 1.25  | 7.5  | 3320-5.00TWMK  | EZ-450-5  | 3320-5.00TWMSSK  |        | 10 | 6.9   | M8-1.25  | 3300-1 |
| 6.00  | 1.00 | 10.00 X 1.50 | 10.5 | 3320-6.00TWMK  | EZ-450-6  | 3320-6.00TWMSSK  |        | 10 | 8.6   | M10-1.5  | 3300-3 |
| 8.00  | 1.25 | 12.00 X 1.75 | 12.5 | 3320-8.00TWMK  | EZ-450-8  | 3320-8.00TWMSSK  |        | 10 | 10.4  | M12-1.75 | 3300-4 |
| 10.00 | 1.50 | 16.00 X 2.00 | 17.0 | 3320-10.00TWMK | EZ-450-10 | 3320-10.00TWMSSK |        | 10 | 14.0  | M16-2.0  | 3300-5 |
| 12.00 | 1.75 | 16.00 X 2.00 | 17.0 | 3320-12.00TWMK |           | 3320-12.00TWMSSK |        | 10 | 14.0  | M16-2.0  | 3300-6 |
| 16.00 | 2.00 | 24.00 X 3.00 | 20.0 | 3320-16.00TWMK |           |                  |        | 5  | 21.0  | M24-3.0  | 3300-8 |

| GROUP           | EZST                |
|-----------------|---------------------|
| INSERT TYPE     | BONDSERT FOR METAL  |
| INSERT MATERIAL | C12L14 CARBON STEEL |
| STYLE           | THIN WALL           |

**METRIC SERIES – RANGE KIT**

| MM    | MM   | MM X MM      | MM   | PART #   | REF. # | #  |
|-------|------|--------------|------|----------|--------|----|
| 5.00  | 0.80 | 8.00 X 1.25  | 7.5  | 3320-WK1 |        | 10 |
| 6.00  | 1.00 | 10.00 X 1.50 | 10.5 |          |        | 10 |
| 8.00  | 1.25 | 12.00 X 1.75 | 12.5 |          |        | 10 |
| 10.00 | 1.50 | 16.00 X 2.00 | 17.0 |          |        | 10 |
| 12.00 | 1.75 | 16.00 X 2.00 | 17.0 |          |        | 10 |





| GROUP           | EZST                       | EZST                       |
|-----------------|----------------------------|----------------------------|
| INSERT TYPE     | BONDSERT FOR METAL         | BONDSERT FOR METAL         |
| INSERT MATERIAL | <b>C12L14 CARBON STEEL</b> | <b>303 STAINLESS STEEL</b> |
| STYLE           | <b>HEAVY WALL</b>          | <b>HEAVY WALL</b>          |

**UNC / UNF SERIES**

| INCH        | TPI       | INCH X TPI | INCH  | PART #              | REF. #     | PART #                | REF. # | #  | DRILL | TAP     | PART # |
|-------------|-----------|------------|-------|---------------------|------------|-----------------------|--------|----|-------|---------|--------|
| <b>10G</b>  | <b>24</b> | 3/8 X 16   | 0.406 | <b>3332-10GHWK</b>  | EZ-329-3   | <b>3332-10GHWSSK</b>  |        | 10 | 5/16  | 3/8-16  | 3300-2 |
| <b>10G</b>  | <b>32</b> | 3/8 X 16   | 0.406 | <b>3334-10GHWK</b>  | EZ-329-332 | <b>3334-10GHWSSK</b>  |        | 10 | 5/16  | 3/8-16  | 3300-2 |
| <b>1/4</b>  | <b>20</b> | 7/16 X 14  | 0.437 | <b>3332-1/4HWK</b>  | EZ-329-4   | <b>3332-1/4HWSSK</b>  |        | 10 | 23/64 | 7/16-14 | 3300-3 |
| <b>1/4</b>  | <b>28</b> | 7/16 X 14  | 0.437 | <b>3334-1/4HWK</b>  | EZ-329-428 |                       |        | 10 | 23/64 | 7/16-14 | 3300-3 |
| <b>5/16</b> | <b>18</b> | 1/2 X 13   | 0.484 | <b>3332-5/16HWK</b> | EZ-329-5   | <b>3332-5/16HWSSK</b> |        | 10 | 27/64 | 1/2-13  | 3300-4 |
| <b>5/16</b> | <b>24</b> | 1/2 X 13   | 0.484 | <b>3334-5/16HWK</b> | EZ-329-524 |                       |        | 10 | 27/64 | 1/2-13  | 3300-4 |
| <b>3/8</b>  | <b>16</b> | 9/16 X 12  | 0.515 | <b>3332-3/8HWK</b>  | EZ-329-6   | <b>3332-3/8HWSSK</b>  |        | 10 | 31/64 | 9/16-12 | 3300-5 |
| <b>3/8</b>  | <b>24</b> | 9/16 X 12  | 0.515 | <b>3334-3/8HWK</b>  | EZ-329-624 |                       |        | 10 | 31/64 | 9/16-12 | 3300-5 |
| <b>7/16</b> | <b>14</b> | 5/8 X 11   | 0.656 | <b>3332-7/16HWK</b> | EZ-329-7   |                       |        | 10 | 17/32 | 5/8-11  | 3300-6 |
| <b>1/2</b>  | <b>13</b> | 3/4 X 10   | 0.656 | <b>3332-1/2HWK</b>  | EZ-329-8   | <b>3332-1/2HWSSK</b>  |        | 10 | 21/32 | 3/4-10  | 3300-7 |
| <b>1/2</b>  | <b>20</b> | 3/4 X 10   | 0.656 | <b>3334-1/2HWK</b>  | EZ-329-820 |                       |        | 10 | 21/32 | 3/4-10  | 3300-7 |
| <b>5/8</b>  | <b>11</b> | 7/8 X 9    | 0.687 | <b>3332-5/8HWK</b>  | EZ-329-10  |                       |        | 5  | 49/64 | 7/8-9   | 3300-9 |

| GROUP           | EZST                       |
|-----------------|----------------------------|
| INSERT TYPE     | BONDSERT FOR METAL         |
| INSERT MATERIAL | <b>C12L14 CARBON STEEL</b> |
| STYLE           | <b>HEAVY WALL</b>          |

**UNC / UNF SERIES – RANGE KIT**

| INCH        | TPI       | INCH X TPI | INCH  | PART #          | REF. #  | #  |
|-------------|-----------|------------|-------|-----------------|---------|----|
| <b>10G</b>  | <b>24</b> | 3/8 X 16   | 0.406 | <b>3332-WK1</b> | EZ-C108 | 10 |
| <b>1/4</b>  | <b>20</b> | 7/16 X 14  | 0.437 |                 |         | 10 |
| <b>5/16</b> | <b>18</b> | 1/2 X 13   | 0.484 |                 |         | 10 |
| <b>3/8</b>  | <b>16</b> | 9/16 X 12  | 0.515 |                 |         | 10 |
| <b>1/2</b>  | <b>13</b> | 3/4 X 10   | 0.656 |                 |         | 10 |





| GROUP           | EZST                       | EZST                       |
|-----------------|----------------------------|----------------------------|
| INSERT TYPE     | BONDSERT FOR METAL         | BONDSERT FOR METAL         |
| INSERT MATERIAL | <b>C12L14 CARBON STEEL</b> | <b>303 STAINLESS STEEL</b> |
| STYLE           | <b>THIN WALL</b>           | <b>THIN WALL</b>           |

**UNC / UNF SERIES**

| UNC  |     | UNF        |       |                    |         |        |        |            |          |                        |        |
|------|-----|------------|-------|--------------------|---------|--------|--------|------------|----------|------------------------|--------|
| INCH | TPI | INCH X TPI | INCH  | PART #             | REF. #  | PART # | REF. # | DRILL INCH | TAP SIZE | MIN. FULL THREAD DEPTH | PART # |
| 10G  | 24  | 5/16 X 18  | 0.312 | <b>3332-10GTW</b>  | 319-3   |        |        | I          | 5/16-18  | 0.375                  | 3300-2 |
| 10G  | 32  | 5/16 X 18  | 0.312 | <b>3334-10GTW</b>  | 319-332 |        |        | I          | 5/16-18  | 0.375                  | 3300-2 |
| 1/4  | 20  | 3/8 X 16   | 0.375 | <b>3332-1/4TW</b>  | 319-4   |        |        | Q          | 3/8-16   | 0.437                  | 3300-3 |
| 1/4  | 28  | 3/8 X 16   | 0.375 | <b>3334-1/4TW</b>  | 319-428 |        |        | Q          | 3/8-16   | 0.437                  | 3300-3 |
| 5/16 | 18  | 7/16 X 14  | 0.437 | <b>3332-5/16TW</b> | 319-5   |        |        | X          | 7/16-14  | 0.500                  | 3300-4 |
| 5/16 | 24  | 7/16 X 14  | 0.437 | <b>3334-5/16TW</b> | 319-524 |        |        | X          | 7/16-14  | 0.500                  | 3300-4 |
| 3/8  | 16  | 1/2 X 13   | 0.500 | <b>3332-3/8TW</b>  | 319-6   |        |        | 29/64      | 1/2-13   | 0.560                  | 3300-5 |
| 3/8  | 24  | 1/2 X 13   | 0.500 | <b>3334-3/8TW</b>  | 319-624 |        |        | 29/64      | 1/2-13   | 0.560                  | 3300-5 |
| 7/16 | 14  | 9/16 X 12  | 0.560 | <b>3332-7/16TW</b> | 319-7   |        |        | 33/64      | 9/16-12  | 0.620                  | 3300-6 |
| 7/16 | 20  | 9/16 X 12  | 0.560 | <b>3334-7/16TW</b> | 319-720 |        |        | 33/64      | 9/16-12  | 0.620                  | 3300-6 |
| 1/2  | 13  | 5/8 X 11   | 0.620 | <b>3332-1/2TW</b>  | 319-8   |        |        | 37/64      | 5/8-11   | 0.680                  | 3300-7 |
| 1/2  | 20  | 5/8 X 11   | 0.620 | <b>3334-1/2TW</b>  | 319-820 |        |        | 37/64      | 5/8-11   | 0.680                  | 3300-7 |

**METRIC INTERNAL UNC EXTERNAL SERIES**

| UNC   |      | EXTERNAL   |       |                      |         |        |        |            |          |                        |        |
|-------|------|------------|-------|----------------------|---------|--------|--------|------------|----------|------------------------|--------|
| MM    | MM   | INCH X TPI | INCH  | PART #               | REF. #  | PART # | REF. # | DRILL INCH | TAP SIZE | MIN. FULL THREAD DEPTH | PART # |
| 4.00  | 0.70 | 5/16 X 18  | 0.312 | <b>3320-4.00TWF</b>  | 319-M4  |        |        | I          | 5/16-18  | 0.375                  | 3300-1 |
| 5.00  | 0.80 | 5/16 X 18  | 0.312 | <b>3320-5.00TWF</b>  | 319-M5  |        |        | I          | 5/16-18  | 0.375                  | 3300-2 |
| 6.00  | 1.00 | 3/8 X 16   | 0.375 | <b>3320-6.00TWF</b>  | 319-M6  |        |        | Q          | 3/8-16   | 0.437                  | 3300-3 |
| 8.00  | 1.25 | 7/16 X 14  | 0.437 | <b>3320-8.00TWF</b>  | 319-M6  |        |        | X          | 7/16-14  | 0.500                  | 3300-4 |
| 10.00 | 1.50 | 1/2 X 13   | 0.500 | <b>3320-10.00TWF</b> | 319-M10 |        |        | 29/64      | 1/2-13   | 0.560                  | 3300-5 |
| 12.00 | 1.75 | 5/8 X 11   | 0.620 | <b>3320-12.00TWF</b> | 319-M12 |        |        | 37/64      | 5/8-11   | 0.680                  | 3300-6 |

**METRIC SERIES**

| UNC   |      | EXTERNAL     |      |                      |        |                        |        |          |          |                        |        |
|-------|------|--------------|------|----------------------|--------|------------------------|--------|----------|----------|------------------------|--------|
| MM    | MM   | MM X MM      | MM   | PART #               | REF. # | PART #                 | REF. # | DRILL MM | TAP SIZE | MIN. FULL THREAD DEPTH | PART # |
| 3.00  | 0.50 | 6.00 X 1.0   | 6.5  | <b>3320-3.00TWM</b>  | 450-3  | <b>3320-3.00TWMSS</b>  | 453-3  | 5.1      | M6-1.0   | 7.8                    |        |
| 4.00  | 0.70 | 8.00 X 1.25  | 7.5  | <b>3320-4.00TWM</b>  | 450-4  | <b>3320-4.00TWMSS</b>  | 453-4  | 6.9      | M8-1.25  | 9.0                    | 3300-1 |
| 5.00  | 0.80 | 8.00 X 1.25  | 7.5  | <b>3320-5.00TWM</b>  | 450-5  | <b>3320-5.00TWMSS</b>  | 453-5  | 6.9      | M8-1.25  | 9.0                    | 3300-2 |
| 6.00  | 1.00 | 10.00 X 1.50 | 10.5 | <b>3320-6.00TWM</b>  | 450-6  | <b>3320-6.00TWMSS</b>  | 453-6  | 8.6      | M10-1.5  | 12.0                   | 3300-3 |
| 8.00  | 1.25 | 12.00 X 1.75 | 12.5 | <b>3320-8.00TWM</b>  | 450-8  | <b>3320-8.00TWMSS</b>  | 453-8  | 10.4     | M12-1.75 | 14.5                   | 3300-4 |
| 10.00 | 1.50 | 16.00 X 2.00 | 17.0 | <b>3320-10.00TWM</b> | 450-10 | <b>3320-10.00TWMSS</b> | 453-10 | 14.0     | M16-2.0  | 19.0                   | 3300-5 |
| 12.00 | 1.75 | 16.00 X 2.00 | 17.0 | <b>3320-12.00TWM</b> | 450-12 | <b>3320-12.00TWMSS</b> | 453-12 | 14.0     | M16-2.0  | 19.0                   | 3300-6 |
| 16.00 | 2.00 | 24.00 X 3.00 | 20.0 | <b>3320-16.00TWM</b> | 450-16 | <b>3320-16.00TWMSS</b> | 453-16 | 21.0     | M24-3.0  | 24.0                   | 3300-8 |
| 20.00 | 2.50 | 36.00 X 4.00 | 30.0 | <b>3320-20.00TWM</b> | 450-20 |                        |        | 33.0     | M36-4.0  | 35.0                   |        |





| GROUP           | EZST                       | EZST                       |
|-----------------|----------------------------|----------------------------|
| INSERT TYPE     | BONDSERT FOR METAL         | BONDSERT FOR METAL         |
| INSERT MATERIAL | <b>C12L14 CARBON STEEL</b> | <b>303 STAINLESS STEEL</b> |
| STYLE           | <b>HEAVY WALL</b>          | <b>HEAVY WALL</b>          |

**UNC / UNF SERIES**

| INCH | TPI | INCH X TPI | INCH  | PART #           | REF. #   | PART #        | REF. #  | DRILL INCH | TAP SIZE | MIN. FULL THREAD DEPTH | PART #   |  |  |
|------|-----|------------|-------|------------------|----------|---------------|---------|------------|----------|------------------------|----------|--|--|
| 4G   | 40  | 10 X 32    | 0.250 | 3332-4GHW        | 329-004  | 3332-4GHWSS   | 303-004 | 5/32       | 10-32    | 0.281                  |          |  |  |
| 6G   | 32  | 1/4 X 20   | 0.280 | 3332-6GHW        | 329-006  | 3332-6GHWSS   | 303-006 | #7         | 1/4-20   | 0.344                  | 3300-006 |  |  |
| 8G   | 32  | 5/16 X 18  | 0.290 | 3332-8GHW        | 329-008  | 3332-8GHWSS   | 303-008 | F          | 5/16-18  | 0.438                  | 3300-1   |  |  |
| 10G  | 24  | 3/8 X 16   | 0.406 | 3332-10GHW       | 329-3    | 3332-10GHWSS  | 303-3   | 5/16       | 3/8-16   | 0.469                  | 3300-2   |  |  |
| 10G  | 32  | 3/8 X 16   | 0.406 | 3334-10GHW       | 329-332  | 3334-10GHWSS  | 303-332 | 5/16       | 3/8-16   | 0.469                  | 3300-2   |  |  |
| 1/4  | 20  | 7/16 X 14  | 0.437 | 3332-1/4HW       | 329-4    | 3332-1/4HWSS  | 303-4   | 23/64      | 7/16-14  | 0.500                  | 3300-3   |  |  |
| 1/4  | 28  | 7/16 X 14  | 0.437 | 3334-1/4HW       | 329-428  | 3334-1/4HWSS  | 303-428 | 23/64      | 7/16-14  | 0.500                  | 3300-3   |  |  |
| 5/16 | 18  | 1/2 X 13   | 0.484 | 3332-5/16HW      | 329-5    | 3332-5/16HWSS | 303-5   | 27/64      | 1/2-13   | 0.563                  | 3300-4   |  |  |
| 5/16 | 24  | 1/2 X 13   | 0.484 | 3334-5/16HW      | 329-524  | 3334-5/16HWSS | 303-524 | 27/64      | 1/2-13   | 0.563                  | 3300-4   |  |  |
| 3/8  | 16  | 9/16 X 12  | 0.515 | 3332-3/8HW       | 329-6    | 3332-3/8HWSS  | 303-6   | 31/64      | 9/16-12  | 0.594                  | 3300-5   |  |  |
| 3/8  | 24  | 9/16 X 12  | 0.515 | 3334-3/8HW       | 329-624  | 3334-3/8HWSS  | 303-624 | 31/64      | 9/16-12  | 0.594                  | 3300-5   |  |  |
| 7/16 | 14  | 5/8 X 11   | 0.656 | 3332-7/16HW      | 329-7    | 3332-7/16HWSS | 303-7   | 17/32      | 5/8-11   | 0.719                  | 3300-6   |  |  |
| 7/16 | 24  | 5/8 X 11   | 0.656 | 3334-7/16HW      | 329-720  | 3334-7/16HWSS | 303-720 | 17/32      | 5/8-11   | 0.719                  | 3300-6   |  |  |
| 1/2  | 13  | 3/4 X 10   | 0.656 | 3332-1/2HW       | 329-8    | 3332-1/2HWSS  | 303-8   | 21/32      | 3/4-10   | 0.750                  | 3300-7   |  |  |
| 1/2  | 13  | 3/4 X 10   | 1.000 | 3332-1/2X1HW     | 329-801  |               |         | 21/32      | 3/4-10   | 1.125                  | 3300-7   |  |  |
| 1/2  | 20  | 3/4 X 10   | 0.656 | 3334-1/2HW       | 329-820  | 3334-1/2HWSS  | 303-820 | 21/32      | 3/4-10   | 0.750                  | 3300-7   |  |  |
| 9/16 | 12  | 3/4 X 10   | 0.656 | 3332-9/16HW      | 329-9    |               |         | 21/32      | 3/4-10   | 0.750                  | 3300-7   |  |  |
| 9/16 | 18  | 3/4 X 10   | 0.656 | 3334-9/16HW      | 329-918  |               |         | 21/32      | 3/4-10   | 0.750                  | 3300-7   |  |  |
| 5/8  | 11  | 7/8 X 9    | 0.687 | 3332-5/8HW       | 329-10   | 3332-5/8HWSS  | 303-10  | 49/64      | 7/8-9    | 0.813                  | 3300-8   |  |  |
| 5/8  | 11  | 7/8 X 9    | 1.125 | 3332-5/8X1.125HW | 329-1018 |               |         | 49/64      | 7/8-9    | 1.250                  | 3300-8   |  |  |
| 5/8  | 18  | 7/8 X 9    | 0.687 | 3334-5/8HW       | 329-10F  |               |         | 49/64      | 7/8-9    | 0.813                  | 3300-8   |  |  |
| 3/4  | 10  | 1 X 8      | 0.781 | 3332-3/4HW       | 329-12   | 3332-3/4HWSS  | 303-12  | 7/8        | 1-8      | 0.875                  | 3300-9   |  |  |
| 3/4  | 16  | 1 X 8      | 0.781 | 3334-3/4HW       | 329-1216 |               |         | 7/8        | 1-8      | 0.875                  | 3300-9   |  |  |
| 7/8  | 9   | 1.1/4 X 7  | 1.125 | 3332-7/8HW       | 329-14   |               |         | 1-7/64     | 1.1/4-7  | 1.250                  |          |  |  |
| 7/8  | 14  | 1.1/4 X 7  | 1.125 | 3334-7/8HW       | 329-1414 |               |         | 1-7/64     | 1.1/4-7  | 1.250                  |          |  |  |
| 1    | 8   | 1.3/8 X 12 | 1.250 | 3332-1HW         | 329-16   |               |         | 1-9/32     | 1.3/8-12 | 1.375                  |          |  |  |
| 1    | 14  | 1.3/8 X 12 | 1.250 | 3334-1HW         | 329-1614 |               |         | 1-9/32     | 1.3/8-12 | 1.375                  |          |  |  |

**UNC INTERNAL METRIC EXTERNAL SERIES**

| INCH | TPI | MM X MM      | INCH  | PART #       | REF. #   | PART # | REF. # | DRILL INCH | TAP SIZE | MIN. FULL THREAD DEPTH | PART # |  |  |
|------|-----|--------------|-------|--------------|----------|--------|--------|------------|----------|------------------------|--------|--|--|
| 6G   | 32  | 6.00 X 1.0   | 0.256 | 3332-6GHWM   | 550-006  |        |        | 5.1        | M6-1.0   | 7.8                    |        |  |  |
| 8G   | 32  | 8.00 X 1.25  | 0.295 | 3332-8GHWM   | 550-008  |        |        | 6.9        | M8-1.25  | 9.0                    | 3300-1 |  |  |
| 10G  | 24  | 8.00 X 1.25  | 0.295 | 3332-10GHWM  | 550-1024 |        |        | 6.9        | M8-1.25  | 12.0                   | 3300-2 |  |  |
| 10G  | 32  | 8.00 X 1.25  | 0.295 | 3334-10GHWM  | 550-1032 |        |        | 6.9        | M8-1.25  | 12.0                   | 3300-2 |  |  |
| 1/4  | 20  | 10.00 X 1.50 | 0.413 | 3332-1/4HWM  | 550-1420 |        |        | 8.6        | M10-1.5  | 14.5                   | 3300-3 |  |  |
| 5/16 | 18  | 12.00 X 1.75 | 0.492 | 3332-5/16HWM | 550-5    |        |        | 10.4       | M12-1.75 | 14.5                   | 3300-4 |  |  |
| 3/8  | 16  | 16.00 X 2.00 | 0.669 | 3332-3/8HWM  | 550-6    |        |        | 14.0       | M16-2.0  | 19.0                   | 3300-5 |  |  |
| 1/2  | 13  | 16.00 X 2.00 | 0.669 | 3332-1/2HWM  | 550-8    |        |        | 14.0       | M16-2.0  | 19.0                   | 3300-7 |  |  |



| GROUP           | EZST                       | EZST                       |
|-----------------|----------------------------|----------------------------|
| INSERT TYPE     | BONDSERT FOR METAL         | BONDSERT FOR METAL         |
| INSERT MATERIAL | <b>C12L14 CARBON STEEL</b> | <b>303 STAINLESS STEEL</b> |
| STYLE           | <b>HEAVY WALL</b>          | <b>HEAVY WALL</b>          |

**METRIC INTERNAL UNC EXTERNAL SERIES**

| MM    | MM   | INCH X TPI | INCH  | PART #               | REF. #  | PART #                 | REF. #  | DRILL INCH | TAP SIZE | MIN. FULL THREAD DEPTH | PART # |
|-------|------|------------|-------|----------------------|---------|------------------------|---------|------------|----------|------------------------|--------|
| 6.00  | 1.00 | 3/8 X 16   | 0.406 | <b>3320-6.00HWF</b>  | 650-6   | <b>3320-6.00HWSSF</b>  | 653-6   | 5/16       | 3/8-16   | 0.469                  | 3300-3 |
| 8.00  | 1.25 | 1/2 X 13   | 0.484 | <b>3320-8.00HWF</b>  | 650-8   | <b>3320-8.00HWSSF</b>  | 653-8   | 27/64      | 1/2-13   | 0.563                  | 3300-4 |
| 10.00 | 1.50 | 9/16 X 12  | 0.515 | <b>3320-10.00HWF</b> | 650-10  | <b>3320-10.00HWSSF</b> | 653-10  | 31/64      | 9/16-12  | 0.594                  | 3300-5 |
| 10.00 | 1.25 | 9/16 X 12  | 0.515 | <b>3321-10.00HWF</b> | 650-10F | <b>3320-10.00HWSSF</b> | 653-10F | 31/64      | 9/16-12  | 0.594                  | 3300-5 |
| 12.00 | 1.75 | 3/4 X 10   | 0.656 | <b>3320-12.00HWF</b> | 650-12  | <b>3320-12.00HWSSF</b> | 653-12  | 21/32      | 3/4-10   | 0.750                  | 3300-6 |
| 14.00 | 2.00 | 7/8 X 9    | 0.687 | <b>3320-14.00HWF</b> | 650-14  | <b>3320-14.00HWSSF</b> | 653-14  | 49/64      | 7/8-9    | 0.813                  | 3300-7 |
| 16.00 | 2.00 | 1 X 8      | 0.781 | <b>3320-16.00HWF</b> | 650-16  | <b>3320-16.00HDSSF</b> | 653-16  | 7/8        | 1-8      | 0.875                  | 3300-8 |



| GROUP           | EZST                       | EZST                       |
|-----------------|----------------------------|----------------------------|
| INSERT TYPE     | BONDSERT FOR METAL         | BONDSERT FOR METAL         |
| INSERT MATERIAL | <b>C12L14 CARBON STEEL</b> | <b>303 STAINLESS STEEL</b> |
| STYLE           | <b>EXTRA HEAVY WALL</b>    | <b>EXTRA HEAVY WALL</b>    |

**UNC SERIES**

| INCH | TPI | INCH X TPI | INCH  | PART #              | REF. # | PART # | REF. # | DRILL INCH | TAP SIZE | MIN. FULL THREAD DEPTH | PART # |
|------|-----|------------|-------|---------------------|--------|--------|--------|------------|----------|------------------------|--------|
| 1/4  | 20  | 1/2 X 13   | 0.484 | <b>3332-1/4XHW</b>  | 335-4  |        |        | 27/64      | 1/2-13   | 0.563                  | 3300-3 |
| 5/16 | 18  | 9/16 X 12  | 0.515 | <b>3332-5/16XHW</b> | 335-5  |        |        | 31/64      | 9/16-12  | 0.594                  | 3300-4 |
| 3/8  | 16  | 5/8 X 11   | 0.656 | <b>3332-3/8XHW</b>  | 335-6  |        |        | 17/32      | 5/8-11   | 0.719                  | 3300-5 |
| 1/2  | 13  | 7/8 X 9    | 0.687 | <b>3332-1/2XHW</b>  | 335-8  |        |        | 49/64      | 7/8-9    | 0.813                  |        |
| 5/8  | 11  | 1 X 8      | 0.781 | <b>3332-5/8XHW</b>  | 335-10 |        |        | 7/8        | 1-8      | 0.875                  |        |



**INSERT STYLE**  
**THIN WALL**

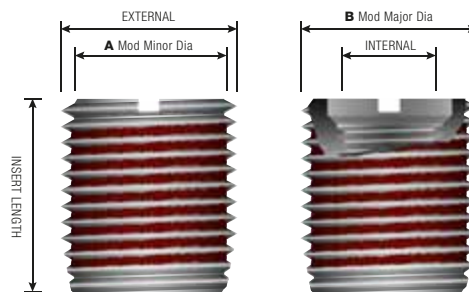

**UNC / UNF SERIES**

| PART #      | INTERNAL THREAD<br>INCH 2B | EXTERNAL THREAD<br>INCH 2B | MATERIAL            | L<br>INCH | A MOD MINOR DIA.<br>INCH | B MAJOR DIA.<br>INCH |
|-------------|----------------------------|----------------------------|---------------------|-----------|--------------------------|----------------------|
| 3332-10GTW  | 10-24                      | 5/16-18                    | C12L14 Carbon Steel | 0.312     | .251 - .254              | .307 - .311          |
| 3334-10GTW  | 10-32                      | 5/16-18                    | C12L14 Carbon Steel | 0.312     | .251 - .254              | .307 - .311          |
| 3332-1/4TW  | 1/4-20                     | 3/8-16                     | C12L14 Carbon Steel | 0.375     | .314 - .318              | .369 - .373          |
| 3334-1/4TW  | 1/4-28                     | 3/8-16                     | C12L14 Carbon Steel | 0.375     | .314 - .318              | .369 - .373          |
| 3332-5/16TW | 5/16-18                    | 7/16-14                    | C12L14 Carbon Steel | 0.437     | .377 - .381              | .432 - .436          |
| 3334-5/16TW | 5/16-24                    | 7/16-14                    | C12L14 Carbon Steel | 0.437     | .377 - .381              | .432 - .436          |
| 3332-3/8TW  | 3/8-16                     | 1/2-13                     | C12L14 Carbon Steel | 0.500     | .434 - .438              | .494 - .498          |
| 3334-3/8TW  | 3/8-24                     | 1/2-13                     | C12L14 Carbon Steel | 0.500     | .434 - .438              | .494 - .498          |
| 3332-7/16TW | 7/16-14                    | 9/16-12                    | C12L14 Carbon Steel | 0.560     | .497 - .501              | .556 - .560          |
| 3334-7/16TW | 7/16-20                    | 9/16-12                    | C12L14 Carbon Steel | 0.560     | .497 - .501              | .556 - .560          |
| 3332-1/2TW  | 1/2-13                     | 5/8-11                     | C12L14 Carbon Steel | 0.620     | .553 - .557              | .619 - .623          |
| 3334-1/2TW  | 1/2-20                     | 5/8-11                     | C12L14 Carbon Steel | 0.620     | .553 - .557              | .619 - .623          |

**METRIC INTERNAL UNC EXTERNAL SERIES**

| PART #        | INTERNAL THREAD<br>MM 6H | EXTERNAL THREAD<br>INCH 2B | MATERIAL            | L<br>INCH | A MOD MINOR DIA.<br>INCH | B MAJOR DIA.<br>INCH |
|---------------|--------------------------|----------------------------|---------------------|-----------|--------------------------|----------------------|
| 3320-4.00TWF  | M4-0.7                   | 5/16-18                    | C12L14 Carbon Steel | 0.312     | .251 - .254              | .307 - .311          |
| 3320-5.00TWF  | M5-0.8                   | 5/16-18                    | C12L14 Carbon Steel | 0.312     | .251 - .254              | .307 - .311          |
| 3320-6.00TWF  | M6-1.0                   | 3/8-16                     | C12L14 Carbon Steel | 0.375     | .314 - .318              | .369 - .373          |
| 3320-8.00TWF  | M8-1.25                  | 7/16-14                    | C12L14 Carbon Steel | 0.437     | .377 - .381              | .432 - .436          |
| 3320-10.00TWF | M10-1.5                  | 1/2-13                     | C12L14 Carbon Steel | 0.500     | .434 - .438              | .494 - .498          |
| 3320-12.00TWF | M12-1.75                 | 5/8-11                     | C12L14 Carbon Steel | 0.625     | .553 - .557              | .619 - .623          |

**INSERT STYLE**  
**THIN WALL**

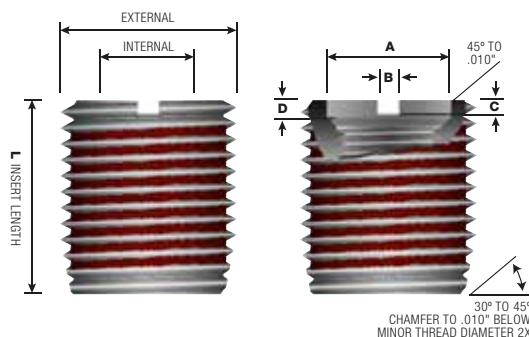

**METRIC SERIES**

| PART #        | INTERNAL THREAD<br>MM 6H | EXTERNAL THREAD<br>MM 6G | MATERIAL            | L<br>MM | A<br>MM | B<br>MM | C<br>MM | D<br>MM |
|---------------|--------------------------|--------------------------|---------------------|---------|---------|---------|---------|---------|
| 3320-3.00TWM  | M3-0.5                   | M6-1.0                   | C12L14 Carbon Steel | 6.5     | 3.25    | 1.14    | 1.57    | 1.91    |
| 3320-4.00TWM  | M4-0.7                   | M8-1.25                  | C12L14 Carbon Steel | 7.5     | 4.32    | 1.65    | 1.65    | 1.91    |
| 3320-5.00TWM  | M5-0.8                   | M8-1.25                  | C12L14 Carbon Steel | 7.5     | 5.33    | 1.65    | 1.65    | 1.91    |
| 3320-6.00TWM  | M6-1.0                   | M10-1.5                  | C12L14 Carbon Steel | 10.5    | 6.35    | 1.83    | 1.83    | 2.03    |
| 3320-8.00TWM  | M8-1.25                  | M12-1.75                 | C12L14 Carbon Steel | 12.5    | 8.33    | 1.83    | 1.83    | 2.03    |
| 3320-10.00TWM | M10-1.5                  | M16-2.0                  | C12L14 Carbon Steel | 17.0    | 10.31   | 2.62    | 2.16    | 2.41    |
| 3320-12.00TWM | M12-1.75                 | M16-2.0                  | C12L14 Carbon Steel | 17.0    | 12.32   | 3.35    | 2.79    | 2.92    |
| 3320-16.00TWM | M16-2.0                  | M24-3.0                  | C12L14 Carbon Steel | 20.0    | 16.66   | 3.35    | 3.18    | 3.30    |
| 3320-20.00TWM | M20-2.5                  | M36-4.0                  | C12L14 Carbon Steel | 30.0    | 20.50   | 3.35    | 3.35    | 3.56    |

INSERT STYLE

THIN WALL

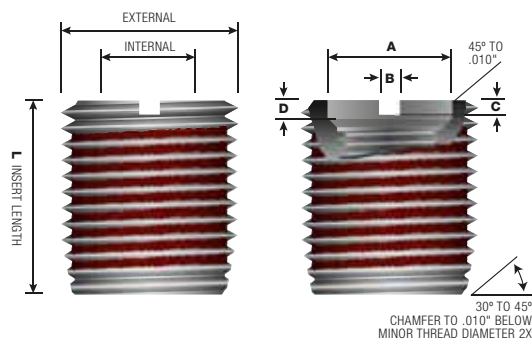

METRIC SERIES

| PART #          | INTERNAL THREAD<br>MM 6H | EXTERNAL THREAD<br>MM 6G | MATERIAL            | L<br>MM | A<br>MM | B<br>MM | C<br>MM | D<br>MM |
|-----------------|--------------------------|--------------------------|---------------------|---------|---------|---------|---------|---------|
| 3320-3.00HWMSS  | M3-0.5                   | M6-1.0                   | 303 Stainless Steel | 6.5     | 3.25    | 1.14    | 1.57    | 1.91    |
| 3320-4.00HWMSS  | M4-0.7                   | M8-1.25                  | 303 Stainless Steel | 7.5     | 4.32    | 1.65    | 1.65    | 1.91    |
| 3320-5.00HWMSS  | M5-0.8                   | M8-1.25                  | 303 Stainless Steel | 7.5     | 5.33    | 1.65    | 1.65    | 1.91    |
| 3320-6.00HWMSS  | M6-1.0                   | M10-1.5                  | 303 Stainless Steel | 10.5    | 6.35    | 1.83    | 1.83    | 2.03    |
| 3320-8.00HWMSS  | M8-1.25                  | M12-1.75                 | 303 Stainless Steel | 12.5    | 8.33    | 1.83    | 1.83    | 2.03    |
| 3320-10.00HWMSS | M10-1.5                  | M16-2.0                  | 303 Stainless Steel | 17.0    | 10.31   | 2.62    | 2.16    | 2.41    |
| 3320-12.00HWMSS | M12-1.75                 | M16-2.0                  | 303 Stainless Steel | 17.0    | 12.32   | 3.35    | 2.79    | 2.92    |
| 3320-16.00HWMSS | M16-2.0                  | M24-3.0                  | 303 Stainless Steel | 20.0    | 16.66   | 3.35    | 3.18    | 3.30    |

INSERT STYLE

HEAVY WALL



UNC / UNF SERIES

| PART #           | INTERNAL THREAD<br>INCH 2B | EXTERNAL THREAD<br>INCH 2B | MATERIAL            | L<br>INCH | A<br>INCH | B<br>INCH | C<br>INCH | D<br>INCH |
|------------------|----------------------------|----------------------------|---------------------|-----------|-----------|-----------|-----------|-----------|
| 3332-4GHW        | 4-40                       | 10-32                      | C12L14 Carbon Steel | 0.250     | 0.122     | 0.064     | 0.062     | 0.065     |
| 3332-6GHW        | 6-32                       | 1/4-20                     | C12L14 Carbon Steel | 0.280     | 0.148     | 0.064     | 0.062     | 0.070     |
| 3332-8GHW        | 8-32                       | 5/16-18                    | C12L14 Carbon Steel | 0.290     | 0.177     | 0.064     | 0.062     | 0.075     |
| 3332-10GHW       | 10-24                      | 3/8-16                     | C12L14 Carbon Steel | 0.406     | 0.201     | 0.064     | 0.070     | 0.080     |
| 3334-10GHW       | 10-32                      | 3/8-16                     | C12L14 Carbon Steel | 0.406     | 0.201     | 0.064     | 0.070     | 0.080     |
| 3332-1/4HW       | 1/4-20                     | 7/16-14                    | C12L14 Carbon Steel | 0.437     | 0.261     | 0.072     | 0.075     | 0.085     |
| 3334-1/4HW       | 1/4-28                     | 7/16-14                    | C12L14 Carbon Steel | 0.437     | 0.261     | 0.072     | 0.075     | 0.085     |
| 3332-5/16HW      | 5/16-18                    | 1/2-13                     | C12L14 Carbon Steel | 0.484     | 0.323     | 0.081     | 0.080     | 0.090     |
| 3334-5/16HW      | 5/16-24                    | 1/2-13                     | C12L14 Carbon Steel | 0.484     | 0.323     | 0.081     | 0.080     | 0.090     |
| 3332-3/8HW       | 3/8-16                     | 9/16-12                    | C12L14 Carbon Steel | 0.515     | 0.386     | 0.091     | 0.085     | 0.095     |
| 3334-3/8HW       | 3/8-24                     | 9/16-12                    | C12L14 Carbon Steel | 0.515     | 0.386     | 0.091     | 0.085     | 0.095     |
| 3332-7/16HW      | 7/16-14                    | 5/8-11                     | C12L14 Carbon Steel | 0.656     | 0.447     | 0.130     | 0.110     | 0.115     |
| 3334-7/16HW      | 7/16-24                    | 5/8-11                     | C12L14 Carbon Steel | 0.656     | 0.447     | 0.130     | 0.110     | 0.115     |
| 3332-1/2HW       | 1/2-13                     | 3/4-10                     | C12L14 Carbon Steel | 0.656     | 0.510     | 0.130     | 0.110     | 0.115     |
| 3332-1/2X1HW     | 1/2-13                     | 3/4-10                     | C12L14 Carbon Steel | 1.000     | 0.510     | 0.130     | 0.110     | 0.115     |
| 3334-1/2HW       | 1/2-20                     | 3/4-10                     | C12L14 Carbon Steel | 0.656     | 0.510     | 0.130     | 0.110     | 0.115     |
| 3332-9/16HW      | 9/16-12                    | 3/4-10                     | C12L14 Carbon Steel | 0.656     | 0.578     | 0.130     | 0.110     | 0.115     |
| 3334-9/16HW      | 9/16-18                    | 3/4-10                     | C12L14 Carbon Steel | 0.656     | 0.578     | 0.130     | 0.110     | 0.115     |
| 3332-5/8HW       | 5/8-11                     | 7/8-9                      | C12L14 Carbon Steel | 0.687     | 0.640     | 0.130     | 0.125     | 0.130     |
| 3332-5/8X1.125HW | 5/8-11                     | 7/8-9                      | C12L14 Carbon Steel | 1.125     | 0.640     | 0.130     | 0.125     | 0.130     |
| 3334-5/8HW       | 5/8-18                     | 7/8-9                      | C12L14 Carbon Steel | 0.687     | 0.640     | 0.130     | 0.125     | 0.130     |
| 3332-3/4HW       | 3/4-10                     | 1-8                        | C12L14 Carbon Steel | 0.781     | 0.765     | 0.130     | 0.125     | 0.130     |
| 3334-3/4HW       | 3/4-16                     | 1-8                        | C12L14 Carbon Steel | 0.781     | 0.765     | 0.130     | 0.125     | 0.130     |
| 3332-7/8HW       | 7/8-9                      | 1.1/4-7                    | C12L14 Carbon Steel | 1.125     | 0.890     | 0.130     | 0.135     | 0.130     |
| 3334-7/8HW       | 7/8-14                     | 1.1/4-7                    | C12L14 Carbon Steel | 1.125     | 0.890     | 0.130     | 0.135     | 0.130     |
| 3332-1HW         | 1-8                        | 1.3/8-12                   | C12L14 Carbon Steel | 1.250     | 1.020     | 0.130     | 0.135     | 0.140     |
| 3334-1HW         | 1-14                       | 1.3/8-12                   | C12L14 Carbon Steel | 1.250     | 1.020     | 0.130     | 0.135     | 0.140     |

**INSERT STYLE**  
**HEAVY WALL**

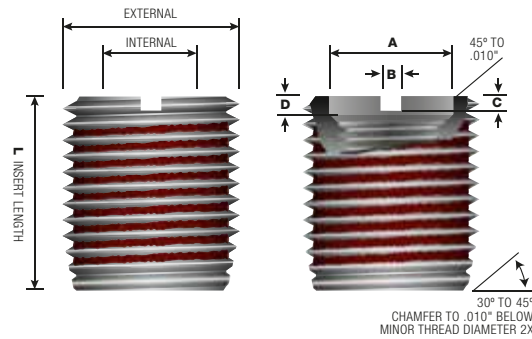

**UNC / UNF SERIES**

| PART #        | INTERNAL THREAD<br>INCH 2B | EXTERNAL THREAD<br>INCH 2B | MATERIAL            | L<br>INCH | A<br>INCH | B<br>INCH | C<br>INCH | D<br>INCH |
|---------------|----------------------------|----------------------------|---------------------|-----------|-----------|-----------|-----------|-----------|
| 3332-4GHWSS   | 4-40                       | 10-32                      | 303 Stainless Steel | 0.250     | 0.122     | 0.064     | 0.602     | 0.065     |
| 3332-6GHWSS   | 6-32                       | 1/4-20                     | 303 Stainless Steel | 0.280     | 0.148     | 0.064     | 0.062     | 0.070     |
| 3332-8GHWSS   | 8-32                       | 5/16-18                    | 303 Stainless Steel | 0.290     | 0.177     | 0.064     | 0.062     | 0.075     |
| 3332-10GHWSS  | 10-24                      | 3/8-16                     | 303 Stainless Steel | 0.406     | 0.201     | 0.064     | 0.070     | 0.080     |
| 3334-10GHWSS  | 10-32                      | 3/8-16                     | 303 Stainless Steel | 0.406     | 0.201     | 0.064     | 0.070     | 0.080     |
| 3332-1/4HWSS  | 1/4-20                     | 7/16-14                    | 303 Stainless Steel | 0.437     | 0.261     | 0.072     | 0.075     | 0.085     |
| 3334-1/4HWSS  | 1/4-28                     | 7/16-14                    | 303 Stainless Steel | 0.437     | 0.261     | 0.072     | 0.075     | 0.085     |
| 3332-5/16HWSS | 5/16-18                    | 1/2-13                     | 303 Stainless Steel | 0.484     | 0.323     | 0.081     | 0.080     | 0.090     |
| 3334-5/16HWSS | 5/16-24                    | 1/2-13                     | 303 Stainless Steel | 0.484     | 0.323     | 0.081     | 0.080     | 0.090     |
| 3332-3/8HWSS  | 3/8-16                     | 9/16-12                    | 303 Stainless Steel | 0.515     | 0.386     | 0.091     | 0.085     | 0.095     |
| 3334-3/8HWSS  | 3/8-24                     | 9/16-12                    | 303 Stainless Steel | 0.515     | 0.386     | 0.091     | 0.085     | 0.095     |
| 3332-7/16HWSS | 7/16-14                    | 5/8-11                     | 303 Stainless Steel | 0.656     | 0.447     | 0.130     | 0.110     | 0.115     |
| 3334-7/16HWSS | 7/16-20                    | 5/8-11                     | 303 Stainless Steel | 0.656     | 0.447     | 0.130     | 0.110     | 0.115     |
| 3332-1/2HWSS  | 1/2-13                     | 3/4-10                     | 303 Stainless Steel | 0.656     | 0.510     | 0.130     | 0.110     | 0.115     |
| 3334-1/2HWSS  | 1/2-20                     | 3/4-10                     | 303 Stainless Steel | 0.656     | 0.510     | 0.130     | 0.110     | 0.115     |
| 3332-5/8HWSS  | 5/8-11                     | 7/8-9                      | 303 Stainless Steel | 0.687     | 0.640     | 0.130     | 0.125     | 0.130     |
| 3332-3/4HWSS  | 3/4-10                     | 1-8                        | 303 Stainless Steel | 0.781     | 0.765     | 0.130     | 0.125     | 0.130     |



**UNC INTERNAL METRIC EXTERNAL SERIES**

| PART #       | INTERNAL THREAD<br>INCH 2B | EXTERNAL THREAD<br>MM 6G | MATERIAL            | L<br>INCH | A<br>INCH | B<br>INCH | C<br>INCH | D<br>INCH |
|--------------|----------------------------|--------------------------|---------------------|-----------|-----------|-----------|-----------|-----------|
| 3332-6GHWM   | 6-32                       | M6-1.0                   | C12L14 Carbon Steel | 0.256     | 0.148     | 0.064     | 0.062     | 0.070     |
| 3332-8GHWM   | 8-32                       | M8-1.25                  | C12L14 Carbon Steel | 0.295     | 0.177     | 0.064     | 0.062     | 0.075     |
| 3332-10GHWM  | 10-24                      | M8-1.25                  | C12L14 Carbon Steel | 0.295     | 0.201     | 0.064     | 0.070     | 0.080     |
| 3334-10GHWM  | 10-32                      | M8-1.25                  | C12L14 Carbon Steel | 0.295     | 0.201     | 0.064     | 0.070     | 0.080     |
| 3332-1/4HWM  | 1/4-20                     | M10-1.5                  | C12L14 Carbon Steel | 0.413     | 0.261     | 0.072     | 0.075     | 0.085     |
| 3332-5/16HWM | 5/16-18                    | M12-1.75                 | C12L14 Carbon Steel | 0.492     | 0.323     | 0.081     | 0.080     | 0.090     |
| 3332-3/8HWM  | 3/8-16                     | M16-2.0                  | C12L14 Carbon Steel | 0.669     | 0.386     | 0.091     | 0.085     | 0.095     |
| 3332-1/2HWM  | 1/2-13                     | M16-2.0                  | C12L14 Carbon Steel | 0.669     | 0.510     | 0.130     | 0.110     | 0.115     |

**METRIC INTERNAL UNC EXTERNAL SERIES**

| PART #        | INTERNAL THREAD<br>MM 6H | EXTERNAL THREAD<br>INCH 2B | MATERIAL            | L<br>INCH | A<br>INCH | B<br>INCH | C<br>INCH | D<br>INCH |
|---------------|--------------------------|----------------------------|---------------------|-----------|-----------|-----------|-----------|-----------|
| 3320-6.00HWF  | M6-1.0                   | 3/8-16                     | C12L14 Carbon Steel | 0.406     | 0.246     | 0.064     | 0.070     | 0.085     |
| 3320-8.00HWF  | M8-1.25                  | 1/2-13                     | C12L14 Carbon Steel | 0.484     | 0.323     | 0.081     | 0.080     | 0.090     |
| 3320-10.00HWF | M10-1.5                  | 9/16-12                    | C12L14 Carbon Steel | 0.515     | 0.403     | 0.091     | 0.085     | 0.095     |
| 3321-10.00HWF | M10-1.25                 | 9/16-12                    | C12L14 Carbon Steel | 0.515     | 0.403     | 0.091     | 0.085     | 0.095     |
| 3320-12.00HWF | M12-1.75                 | 3/4-10                     | C12L14 Carbon Steel | 0.656     | 0.482     | 0.130     | 0.110     | 0.115     |
| 3320-14.00HWF | M14-2.0                  | 7/8-9                      | C12L14 Carbon Steel | 0.687     | 0.640     | 0.130     | 0.125     | 0.130     |
| 3320-16.00HWF | M16-2.0                  | 1-8                        | C12L14 Carbon Steel | 0.781     | 0.640     | 0.130     | 0.125     | 0.130     |



INSERT STYLE  
HEAVY WALL

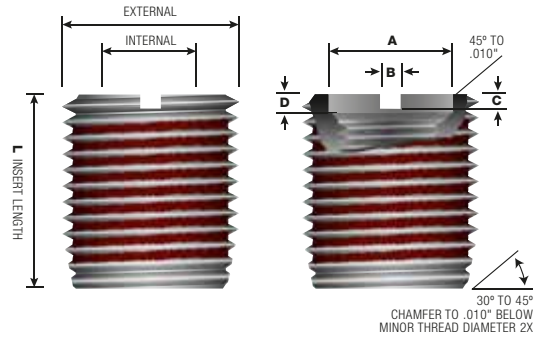

METRIC INTERNAL UNC EXTERNAL SERIES

| PART #          | INTERNAL THREAD<br>MM 6H | EXTERNAL THREAD<br>INCH 2B | MATERIAL            | L<br>MM | A<br>MM | B<br>MM | C<br>MM | D<br>MM |
|-----------------|--------------------------|----------------------------|---------------------|---------|---------|---------|---------|---------|
| 3320-6.00HWSSF  | M6-1.0                   | 3/8-16                     | 303 Stainless Steel | 0.406   | 0.246   | 0.064   | 0.070   | 0.085   |
| 3320-8.00HWSSF  | M8-1.25                  | 1/2-13                     | 303 Stainless Steel | 0.484   | 0.323   | 0.081   | 0.080   | 0.090   |
| 3320-10.00HWSSF | M10-1.5                  | 9/16-12                    | 303 Stainless Steel | 0.515   | 0.403   | 0.091   | 0.085   | 0.095   |
| 3321-10.00HWSSF | M10-1.25                 | 9/16-12                    | 303 Stainless Steel | 0.515   | 0.403   | 0.091   | 0.085   | 0.095   |
| 3320-12.00HWSSF | M12-1.75                 | 3/4-10                     | 303 Stainless Steel | 0.656   | 0.482   | 0.130   | 0.110   | 0.115   |
| 3320-14.00HWSSF | M14-2.0                  | 7/8-9                      | 303 Stainless Steel | 0.687   | 0.640   | 0.130   | 0.125   | 0.130   |
| 3320-16.00HWSSF | M16-2.0                  | 1-8                        | 303 Stainless Steel | 0.781   | 0.640   | 0.130   | 0.125   | 0.130   |

INSERT STYLE  
EXTRA HEAVY WALL

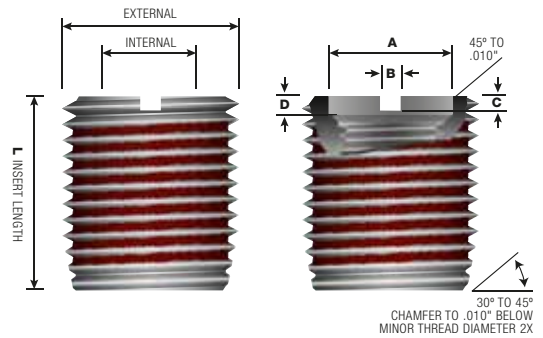

UNC SERIES

| PART #       | INTERNAL THREAD<br>INCH 2B | EXTERNAL THREAD<br>INCH 2B | MATERIAL            | L<br>INCH | A<br>INCH | B<br>INCH | C<br>INCH | D<br>INCH |
|--------------|----------------------------|----------------------------|---------------------|-----------|-----------|-----------|-----------|-----------|
| 3332-1/4XHW  | 1/4-20                     | 1/2-13                     | C12L14 Carbon Steel | 0.484     | 0.261     | 0.072     | 0.075     | 0.085     |
| 3332-5/16XHW | 5/16-18                    | 9/16-12                    | C12L14 Carbon Steel | 0.515     | 0.323     | 0.081     | 0.080     | 0.090     |
| 3332-3/8XHW  | 3/8-16                     | 5/8-11                     | C12L14 Carbon Steel | 0.656     | 0.385     | 0.130     | 0.110     | 0.115     |
| 3332-1/2XHW  | 1/2-13                     | 7/8-9                      | C12L14 Carbon Steel | 0.687     | 0.640     | 0.130     | 0.125     | 0.130     |
| 3332-5/8XHW  | 5/8-11                     | 1-8                        | C12L14 Carbon Steel | 0.781     | 0.760     | 0.130     | 0.125     | 0.130     |



# bondsert



**CROSSROAD DISTRIBUTOR SOURCE**

15340 Herriman Blvd,  
Noblesville, IN 46060  
Sales@Crossroad.bz

[CrossroadDistributorSource.com](http://CrossroadDistributorSource.com)

TEL: 317.723.5050 FAX: 317.723.5052